

KAPPA-100 / KAPPA-100/C

Medium Pressure Diaphragm Pump

KAPPA-100 & KAPPA-100/C medium pressure diaphragm pumps are excellent for various horticultural, agricultural, lawn care, nursery and turf spraying applications. They are also effectively utilized in other applications such as hydrostatic testing, fire fighting and cleaning. Simplicity of design and common parts allow easy and affordable maintenance. Built-in pulsation dampener, control valve and pressure gauge are standard.



Several drive options are available, including:

Part Number	Description
4155.00	Hydraulic Motor Mounting Kit
5034.B5	16 - 20 HP Gear Reduction
7751.A3	1" Solid Keyed Shaft and Bolts
7753.A6*	1-3/8" 6-Spline Male Shaft & Bolts

For industrial uses and spraying applications not listed, please consult UDOR U.S.A.

* For ALL PTO Drive Applications, Safety Shield (Part #1219.02) is Recommended

SPECIFICATIONS

Maximum Flow	26 GPM
Maximum Pressure	560 PSI
Maximum Temperature	140°F
Hose Barb Ports	
In	1-1/2"
Out (Ball Valve Controlled)	1/2" (2)
Bypass	3/4"
Dimensions	L-15.5" x W-16" x H-12.5"
Weight	51 lbs.
Diaphragm Material	
Standard	DESMOPAN
Optional	BUNA-N

NOTE - Protect pumps from freezing. If freezing conditions exist, flush pump and system with a 50/50 mixture of anti-freeze and water.

UDOR U.S.A., INC.

KAPPA-100 / KAPPA-100/C - Exploded View Diagram and Parts List

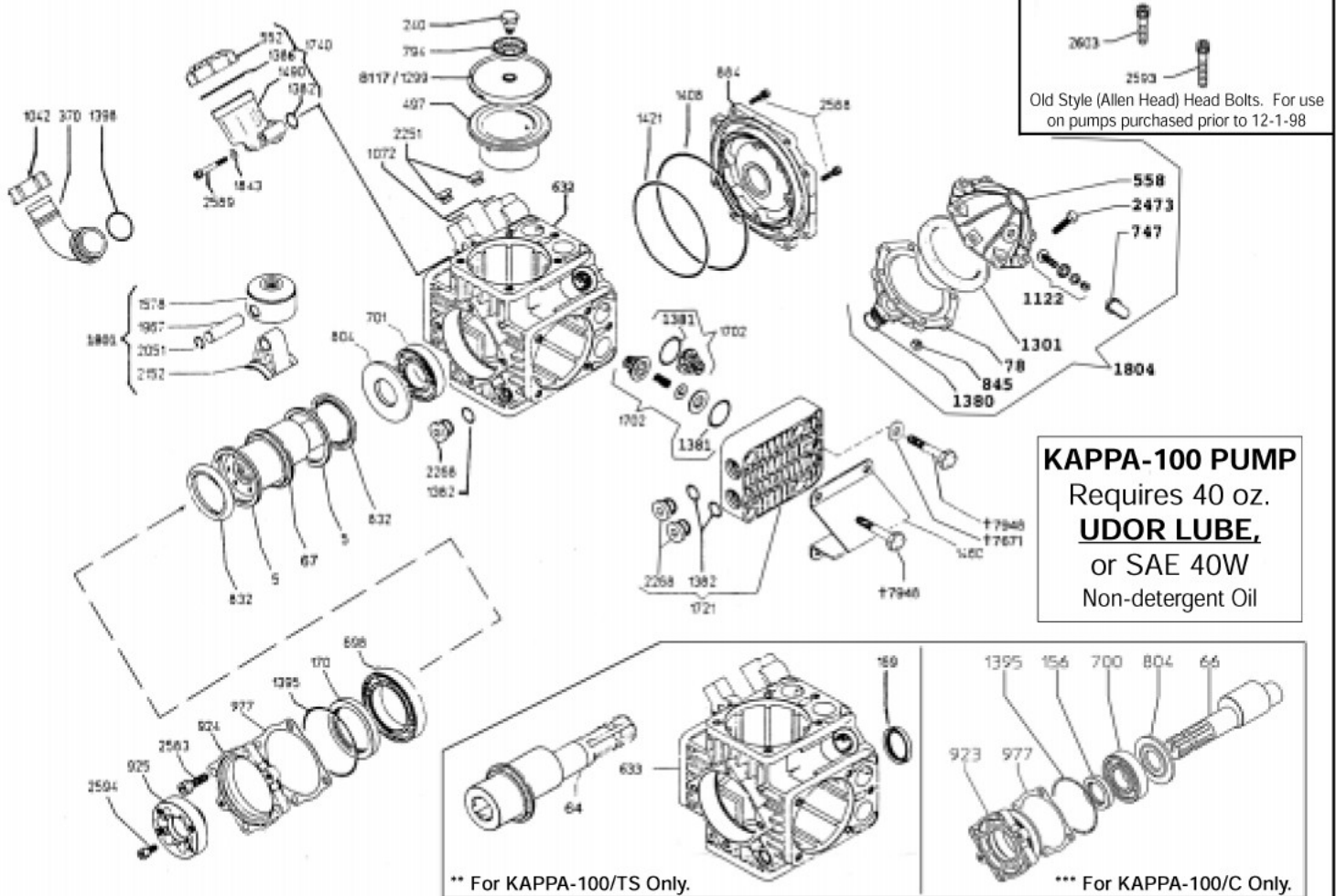

REF#	PART#	DESCRIPTION	QTY	REF#	PART#	DESCRIPTION	QTY
	5	Retainer Ring	2	1380	1101.25	O-Ring	1
**	64	Crankshaft (Thru-shaft)	1	*1381	1101.27	O-Ring	8
***	66	Crankshaft (KAPPA-100/C)	1	1382	1101.29	O-Ring	10
	67	Crankshaft	1	1386	1101.33	O-Ring	1
	78	Pressure Accumulator	1	1395	1101.48	O-Ring	1
***	156	Shaft Seal (KAPPA-100/C)	1	1398	1101.42	O-Ring	1
**	169	Seal for Thru-Shaft Body	1	1408	1101.63	O-Ring	1
	170	Seal	1	1421	1101.88	O-Ring	1
	240	Diaphragm Bolt	4	1460	1202.37	Mounting Rail	2
	370	Suction Elbow	1	1490	1203.27	Oil Reservoir	1
	497	Piston Sleeve	4	1578	1205.18	Piston	4
	552	Oil Reservoir Cap	1	1702	6006.01	Valve Assembly	8
	558	Accumulator Head	1	1721	6017.06	Head Assembly	4
	632	Pump Body	1	1740	6033.01	Oil Reservoir	1
**	633	Pump Body - Thru-Shaft	1	1801	6015.29	Piston/Rod Assembly	4
	698	Ball Bearing	1	1804	6031.02	Accumulator Assembly	1
***	700	Ball Bearing (KAPPA-100/C)	1	1843	1403.07	Washer	2
	701	Ball Bearing	1	1845	1403.10	Washer	6
	747	Air Valve Cap Protector	1	1967	1502.07	Connecting Rod Pin	4
	794	Retainer Washer	4	2051	1506.15	Snap Ring	8
	804	Spacer (2 Req'd for KAPPA-100/C)	1	2152	1519.19	Connecting Rod	4
	832	Washer	2	2251	1603.02	Oil Plug	2
	845	Nut	8	2268	1603.32	Head Plug	9
	871	Self-Locking Nut	2	2473	1804.54	Bolt, M8 x 40	8
	884	Manifold Cover	1	2583	1805.05	Bolt	4
***	923	Flange (KAPPA-100/C)	1	2588	1805.21	Bolt	12
	924	Flange	1	2589	1805.26	Bolt	2
	925	Shaft Adapter	1	2593	1805.14	Rail Mtg. Head Bolt (Allen Head, Old Style)	8
	977	Gasket	1	2594	1805.24	Bolt	6
	1042	Suction Nut	1	2603	1805.12	Head Bolt M10 x 50 (Allen Head, Old Style)	12
	1072	Aluminum Gasket	2	†7671	1403.09	Washer - Head Bolt	12
	1122	Air Valve Assembly	1	†7948	1804.45	Head Bolt - Hex Head	20
	1299	Piston Diaphragm	4	*8117	0903.38	DESOMOPAN Piston Diaphragm	4
*1301	0903.16	Accumulator Diaphragm	1				

* Parts Included in Diaphragm Repair Kit - #8700.24. (Also available in Buna-N - #8700.23.)

† For use with new style heads purchased after 12-1-98.