

# BETA-200/CC & BETA-240/CC

## *High Pressure Diaphragm Pump*

BETA-200/CC and BETA-240/CC six-cylinder, high pressure, high volume diaphragm pumps are excellent for various horticultural and agricultural spraying applications. Simplicity of design and common parts allow easy and affordable maintenance. Control valve and pressure gauge are standard.

The BETA-200/CC and BETA-240/CC are constructed of brass and stainless steel with brass and stainless steel liquid handling parts.

For industrial uses and spraying applications not listed, please consult UDOR U.S.A.

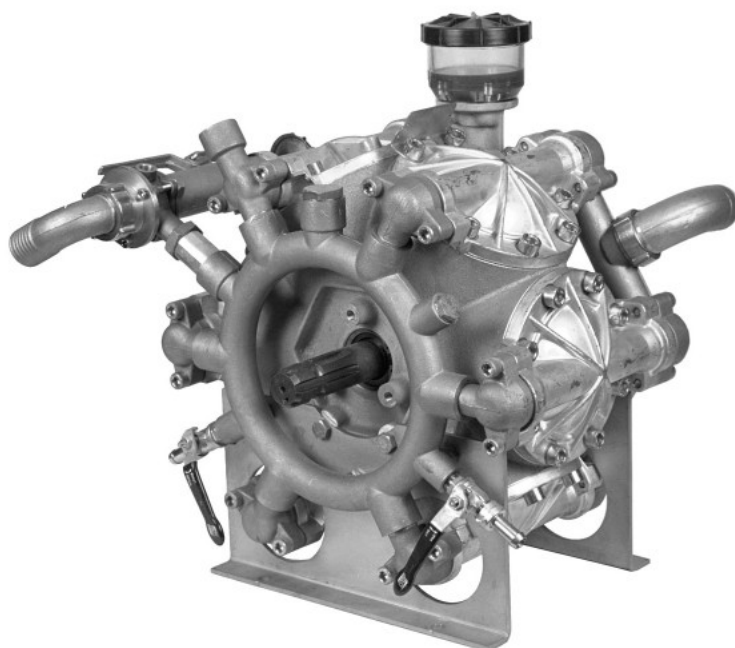

### **SPECIFICATIONS**

Maximum Flow	
BETA-200/CC .....	58 GPM
BETA-240/CC .....	64 GPM
Maximum Pressure .....	700 PSI
Maximum RPM .....	540 RPM
Maximum Temperature .....	140°F
Inlet Ports (Hose Barb) .....	1-1/2"(2)
Outlet Ports	
Hose Barb (Ball Valve Controlled) .....	1/2" (2)
FNPT .....	3/4"(2)
Bypass (Hose Barb) .....	1-1/4"
Dimensions .....	L-15" x W-17" x H-21"
Weight .....	200 lbs.
Diaphragm Material	
Standard .....	DESMOPAN
Optional .....	BUNA-N

NOTE - Protect pumps from freezing. If freezing conditions exist, flush pump and system with a 50/50 mixture of anti-freeze and water.

**UDOR U.S.A., INC.**

# BETA-200/CC & BETA-240/CC - Exploded View Diagram and Parts List

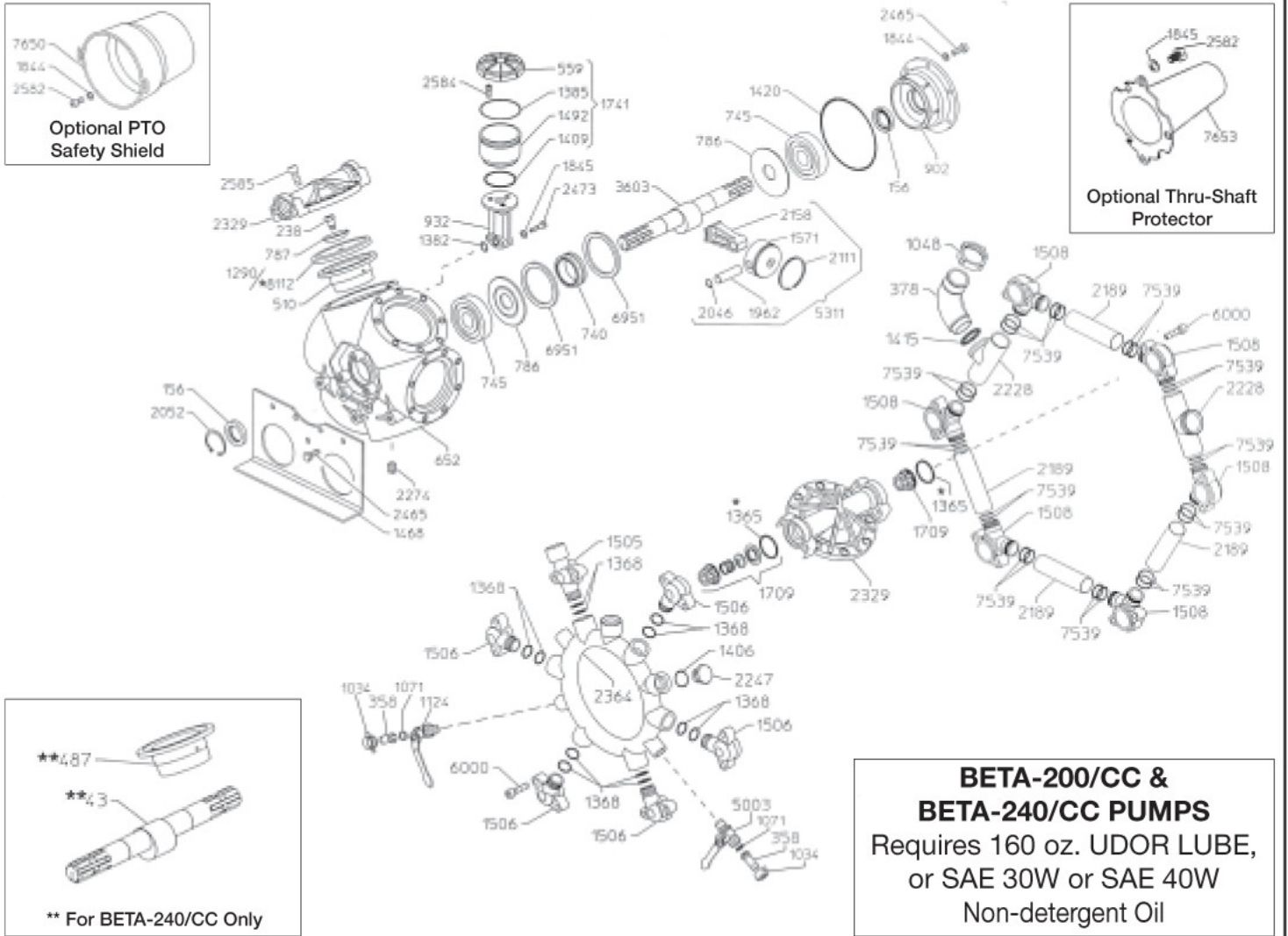

REF#	PART#	DESCRIPTION	QTY	REF#	PART#	DESCRIPTION	QTY
**43	02-0002.29	Crankshaft (BETA-240)	1	1506	02-1203.46	Elbow	5
156	02-0007.02	Seal	2	1508	02-1203.51	Elbow	6
238	02-0102.01	Diaphragm Bolt	6	1571	02-1205.08	Piston	6
358	02-0202.19	Brass Barb	2	1709	02-6006.08	Valve Assembly	12
378	02-0202.84	Hose Barb Elbow	2	1741	02-6033.02	Oil Reservoir Assembly	1
**487	02-0206.12	Piston Sleeve (BETA-240)	6	1844	02-1403.09	Washer	9
510	02-0206.28	Piston Sleeve (BETA-200)	6	1845	02-1403.10	Washer	5
559	02-0208.22	Oil Cap	1	1962	02-1502.01	Wrist Pin	6
652	02-0209.65	Pump Body	1	2046	02-1506.02	Snap Ring	12
740	02-0216.09	Bearing	2	2052	02-1506.16	Snap Ring	1
745	02-0214.20	Bearing	2	2111	02-1509.05	Piston Ring	6
786	02-0301.02	Spacer	2	2158	02-1519.25	Connecting Rod	6
787	02-0301.03	Diaphragm Washer	6	2189	02-1601.20	Inlet Manifold Tube	4
902	02-0501.46	Flange	1	2228	02-1602.26	Inlet Tube	2
932	02-0501.B1	Oil Reservoir Extension (BETA)	1	2247	02-1603.74	Manifold Plug	1
1034	02-0604.09	Barb Nut	2	2274	02-1603.44	Oil Plug	1
1048	02-0604.48	Barb Nut	2	2329	02-1604.54	Head	6
1071	02-0605.05	Rubber Gasket	2	2465	02-1804.03	Bolt	6
1124	02-0608.45	Ball Valve, Left	1	2473	02-1804.54	Bolt	2
1290	02-0903.01	Piston Diaphragm (BUNA)	6	2582	02-1805.04	Bolt	6
*1365	02-1101.01	O-Ring	12	2584	02-1805.06	Bolt	3
1368	02-1101.04	O-Ring	12	2585	02-1805.08	Bolt	36
1382	02-1101.29	O-Ring	1	3603	02-0002.07	Crankshaft (BETA-200)	1
1385	02-1101.32	O-Ring	1	5003	02-0608.46	Ball Valve, Right	1
1406	02-1101.17	O-Ring	1	5311	02-6015.37	Piston Rod Assembly	6
1409	02-1101.68	O-Ring	1	6000	02-1805.07	Bolt	24
1415	02-1101.77	O-Ring	2	6951	02-0001.10	Retainer Ring	2
1420	02-1101.71	O-Ring	1	7539	02-1101.D7	O-Ring	24
1468	02-1202.52	Mounting Rail	2	7650	02-1219.02	PTO Safety Shield (Optional)	1
1492	02-1203.30	Oil Reservoir	1	7653	02-1219.15	Thru-Shaft Protector (Optional)	1
1505	02-1203.45	Elbow	1	*8112	02-0903.33	Piston Diaphragm (DESMOPAN)	6

\* Parts Included in Diaphragm Repair Kit - #02-8700.55 (Also available in Buna-N - #02-8700.50)